

HITACHI

— air365 Mini Series

Beta version



Cooling & Heating





DC Inverter Dual Rotor Compressor

The DC inverter dual rotor compressor, with a wide frequency range from 15Hz to 130Hz, effectively reduces operating noise and minimizes indoor temperature fluctuations to enhancing indoor comfort and saving energy.

Compact size
and light weight

High speed
and efficiency

Low noise and
energy consumption



Large Fan with DC Motor

The outdoor unit adopts new $\Phi 580\text{mm}$ wide-diameter fan, which enhances energy efficiency at low speeds and increases capacity at high speeds. Equipped with a DC inverter motor, it offers 24-step speed regulation to ensure stable and efficient operation.



Self-cleaning Technology

With every start or stop, the fan automatically reverses for one minute to remove dust accumulated on the surface of the heat exchanger, ensuring heat transfer efficiency and reducing energy consumption.

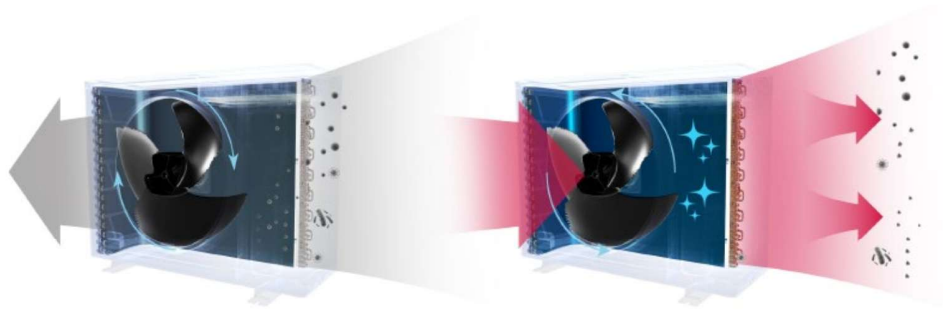

PCB Refrigerant Cooling Technology

Hitachi air365 mini series uses refrigerant cooling technology to cool the electronic control box. It helps overcome poor heat dissipation issue to maintain efficient and reliable operation under high ambient temperatures.

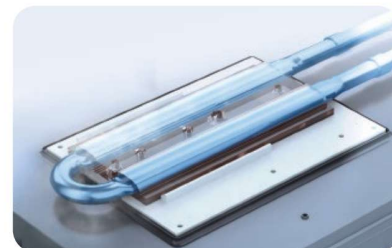



Wide Operation Range

Hitachi air365 mini series can operate in a wide ambient temperature range as low as -21°C for heating and up to 59°C for cooling, ensuring reliable performance for ultimate indoor comfort throughout the year.



Note: The system may operate intermittently within the temperature range from 55°C to 59°C .



1W Standby Mode

Unnecessary energy waste may be caused during long standby periods like holidays or transitional seasons. The Hitachi air365 mini series addresses this issue with its innovative 1W standby mode, slashing your electricity costs like never before.



Low Noise Quiet Mode

Activate quiet mode and immerse yourself in an environment where noise can be reduced by up to 8dB(A), allowing you to enjoy unparalleled serenity and comfort.



Step 1: 5dB(A) decreased; Step 2: 6dB(A) decreased; Step 3: 8dB(A) decreased.



Compact and Lightweight Design

The compact and lightweight design makes transportation and installation effortless while minimizing the floor space occupied, saving you time, effort, and space. Additionally, the mini VRF connects to multiple indoor units with just one pair of pipes, reducing wall damage and simplifying maintenance.

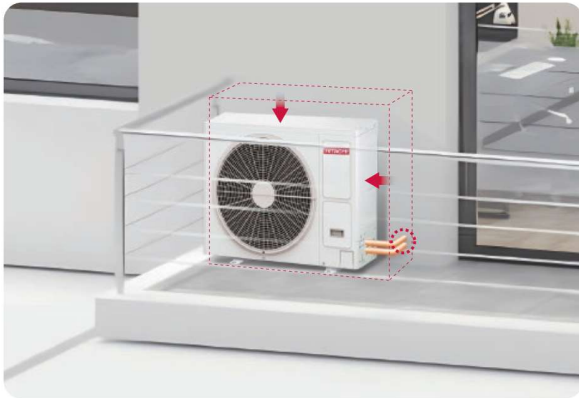

Mini VRF



Multi split



Flexible Piping Design

With extended piping length and higher IDUs connection ratio, Hitachi provides greater flexibility and convenience in system design and installation.

Max. total piping length: **120m**

- ① Max. single piping length: **75m**
- ② Max. length from the first branch pipe to the farthest IDU: **30m**
- ③ Max. height difference between ODU and IDU: **30m**
- ④ Max. height difference between IDUs: **15m**

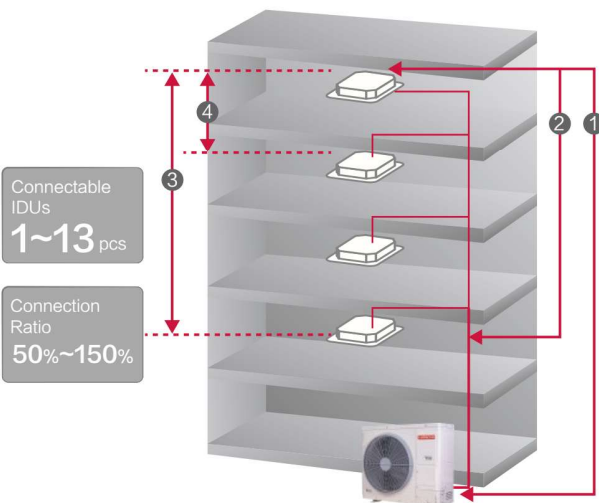

Higher External Static Pressure

With an external static pressure of up to 35Pa, Hitachi air365 mini series allows for longer air discharge distance and prevents airflow short circuit, ensuring effective ventilation.

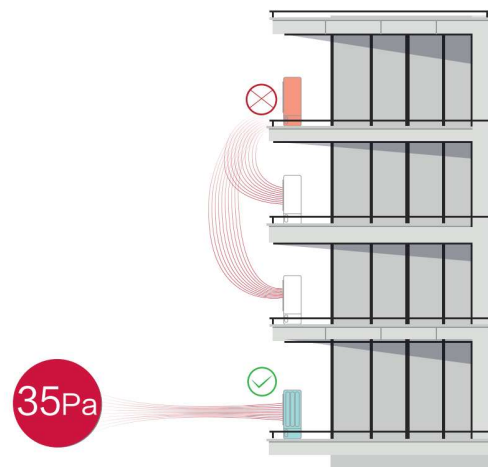

* Note: For detailed information, please contact our technical engineer.



Multiple Piping Connection Options

Hitachi air365 mini series provides installers with three piping connection options: flare-nut branch pipes, welding branch pipes, and head branches. Among them, the head branches are universally compatible with all flare nuts, enabling quick and easy connection to pre-installed refrigerant pipelines, thus making on-site installation more flexible.

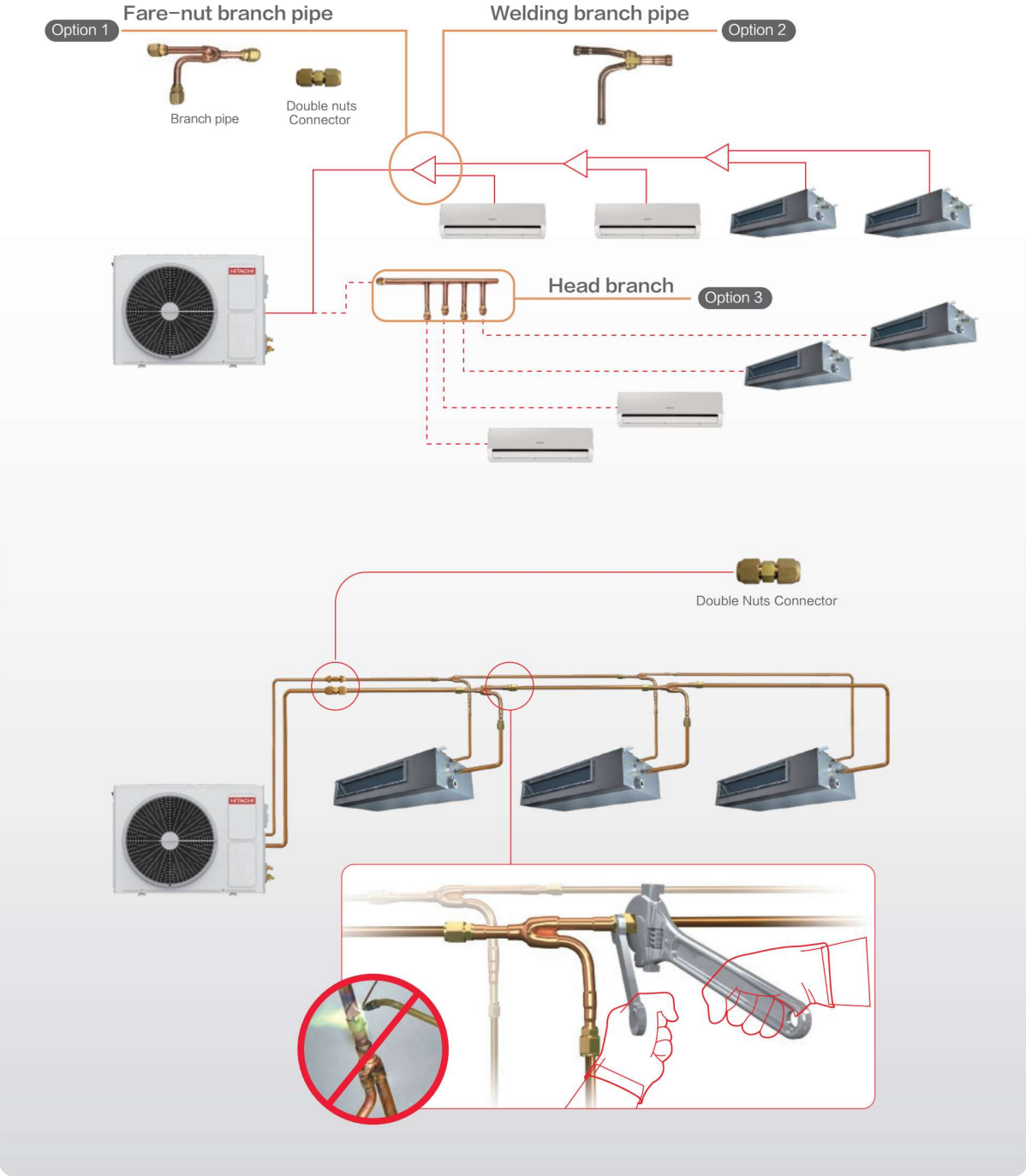

Specification

air365 Mini Series



HP			3	3.5	4	5
Model			RAS-3.0FSLN3QE	RAS-3.5FSLN3QE	RAS-4.0FSLN3QE	RAS-5.0FSLN3QE
Power Supply			1PH 220~240V 50Hz/60Hz			
Cooling	Capacity	kW	8.0	10.0	12.1	14
		kBtu/h	27300	34100	41300	47800
	Power Input	kW	2.03	2.66	3.32	3.88
	EER	kW/kW	3.95	3.76	3.65	3.61
Heating	Capacity	kW	9.5	11.2	14	16
		kBtu/h	32400	38200	47800	54600
	Power Input	kW	2.27	2.67	3.23	3.97
	COP	kW/kW	4.18	4.20	4.33	4.03
Air Flow Rate		m ³ /min	45	45	75	75
Sound Pressure Level(Cooling/Heating)		dB(A)	52/54	53/55	54/55	54/55
Refrigerant	Type		R410A			
	Pre-charged Quantity	kg	1.8	1.8	2.0	3.0
Weight	Net Weight	kg	50	52	64	71
	Gross Weight	kg	54	55	77	83
Dimensions	External (H×W×D)	mm	670×900×320		770×980×360	
	Packing(H×W×D)	mm	717×1056×427		920×1100×505	
Ref. Piping	Gas	mm	Φ15.88	Φ15.88	Φ15.88	Φ15.88
		inch	5/8	5/8	5/8	5/8
	Liquid	mm	Φ9.53	Φ9.53	Φ9.53	Φ9.53
		inch	3/8	3/8	3/8	3/8
Connectable Indoor Units	Quantity	pcs	1~5	1~6	1~7	1~9
	Connection Ratio		50%~150%			
Piping Design	Max. Total piping Length	m	40	40	60	70
	Max. Piping Length	m	25	25	50	60
	Height Difference Between ODU and IDU	m	20	20	30	30
	Height Difference Between IDUs	m	10	10	15	15
Operation Range	Cooling	DB	-5~59※	-5~59※	-5~59※	-5~59※
	Heating	WB/DB	-21~17/-20~23	-21~17/-20~23	-21~17/-20~23	-21~17/-20~23

HP			6	6.5	7	8
Model			RAS-6.0FSLN3QE	RAS-6.5FSLN3QE	RAS-7.0FSLN3QE	RAS-8.0FSLN3QE
Power Supply			1PH 220~240V 50Hz/60Hz			
Cooling	Capacity	kW	15.5	18.1	20	22.4
		kBtu/h	52900	61800	68200	76400
	Power Input	kW	4.37	5.17	6.15	7.94
	EER	kW/kW	3.55	3.5	3.25	2.82
Heating	Capacity	kW	17	20	22.4	25
		kBtu/h	58000	68200	74600	85300
	Power Input	kW	4.24	5.06	5.88	6.65
	COP	kW/kW	4.01	3.95	3.81	3.76
Air Flow Rate		m ³ /min	75	93	93	93
Sound Pressure Level(Cooling/Heating)		dB(A)	54/56	56/58	57/60	57/60
Refrigerant	Type		R410A			
	Pre-charged Quantity	kg	3.0	3.8	3.8	3.8
Weight	Net Weight	kg	71	97	97	97
	Gross Weight	kg	83	110	110	110
Dimensions	External (H×W×D)	mm	770×980×360		1080×980×360	
	Packing(H×W×D)	mm	920×1100×505		1230×1100×505	
Ref. Piping	Gas	mm	Φ15.88	Φ19.05	Φ19.05	Φ19.05
		inch	5/8	3/4	3/4	3/4
	Liquid	mm	Φ9.53	Φ9.53	Φ9.53	Φ9.53
		inch	3/8	3/8	3/8	3/8
Connectable Indoor Units	Quantity	pcs	1~10	1~11	1~12	1~13
	Connection Ratio		50%~150%			
Piping Design	Max. Total piping Length	m	70	120	120	120
	Max. Piping Length	m	60	75	75	75
	Height Difference Between ODU and IDU	m	30	30	30	30
	Height Difference Between IDUs	m	15	15	15	15
Operation Range	Cooling	DB	-5~59※	-5~59※	-5~59※	-5~59※
	Heating	WB/DB	-21~17/-20~23	-21~17/-20~23	-21~17/-20~23	-21~17/-20~23